

The logo for ThermTec, featuring a stylized red 'T' followed by the word 'hermTec' in white lowercase letters.

ThermTec

TS Series

Middle and Long Distance
Single Spectrum PTZ System

TS Series

Middle and Long Distance
Single Spectrum PTZ System



Product Features

- High image quality: 12μm thermal sensor;
- Powerful behavior analysis algorithm: Line crossing, intrusion, region entry & exit;
- Advanced AI algorithm: Multiple targets types detection and tracking;
- Excellent image enhancement: AGC, NUC, IDE, HDR, DNR;
- Rugged PTZ: Aluminium alloy material, waterproof aviation interface, anti-salt spray;
- Superior environmental adaptability: Applicable for extreme weather, including darkness, rain, fog, smog and etc.;
- Complete customizability: Laser range finder, laser illuminator in option.

Dimension

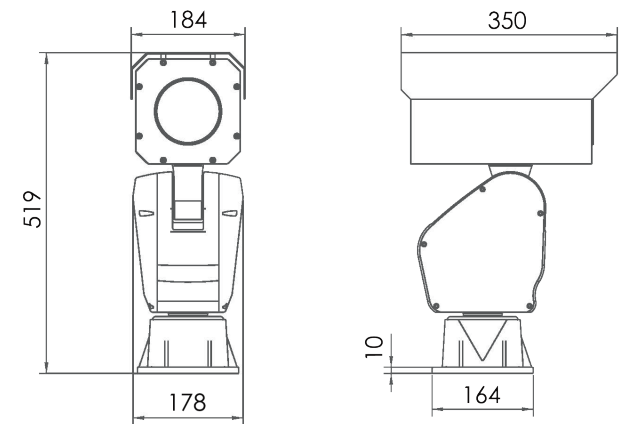

Thermal Module		TS3		TS6	
Resolution/Pixel pitch		384x288/12μm		640x512/12μm	
Spectral range		8-14μm			
NETD		≤35mK			
Focal Length		50mm	75mm	25-75mm	
FOV	TS3	5.3x4.0	3.5x2.6	10.5x7.9~3.5x2.6	
	TS6	8.8x6.6	5.9x4.7	17.5x13~5.9x4.7	
F Number		F1.0			
Optical Zoom		/	/	3X	
Digital Zoom		1-8x continuous			
Focus Method		Motorized			
Image Sensor		Uncooled FPA			
Color Palette		14 color palettes			

Image Effect

Thermal image process algorithm	AGC, NUC, IDE, HDR, DNR
---------------------------------	-------------------------

PTZ

Pan Range	360° continuous
Tilt Range	128°(-88°~+40°)
Pan Speed	0.1°~30°/s max
Tilt Speed	0.1°~15°/s max
Presets	128
Power Off Memory	Support
Positional Accuracy	±0.1°
Auto Horizontal Scan	Preset patrol / Auto line scanning & etc
Repeatability	±0.1°
Actuation	Stepper motor

Smart Function

VCA	4 VCA types (motion detection, cross line, intrusion, area entry and exit), max. 10 VCA rules
Temperature Measurement	3 temperature measurement rule types, 30 rules in total (10 points, 10 areas, and 10 lines).
Temperature Range	-20 °C~+ 150 °C (-4 °F~+ 302°F)
Temperature Accuracy	± 8 °C (± 14.4 °F)
Fire Detection	Support
Thermal image smart function	Human, vehicles, vessels, animals detection

Video and Audio	
Main-Stream	25fps (1280*720,768*576,640*480,384*288,352*288)
Sub-stream	25fps (768*576,640*480,384*288,352*288)
Video Compression	H.265 / H.264

Network

Protocols	IPv4, HTTP, HTTPS, FTP, DNS, NTP, RTSP, RTCP, RTP, TCP, UDP, IGMP, ICMP, DHCP, ONVIF
API	SDK, third-party management platform, ONVIF and CGI
Simultaneous Live View	6 users
User/Host level	Up to 10 users, 3 levels: Administrator, Operator, General
Security	Support password protection, bonding MAC ID, IP filtration
Client	Support ThermTec platform, third-party VMS by ONVIF, etc.
Web Browser	Google Kernel Browser, Edge

Interface

Alarm Input	1ch
Alarm Output	1ch
Audio Input	1ch
Audio Output	1ch
Communication Interface	RJ45 10 M/100 M self-adaptive Ethernet interface RS-485 interface

General

Web Client Language	English
Power Supply	DC 24V
Power Consumption	60W
Work Temperature/Humidity	-20°C~+60°C (-4°F~+140°F), <90%RH
Protection Level	IP66
Dimension	184mmx350mmx519mm
Weight	15kg

Optional

Laser Illuminator	Optional
Laser Range Finder	Optional